

ZETR

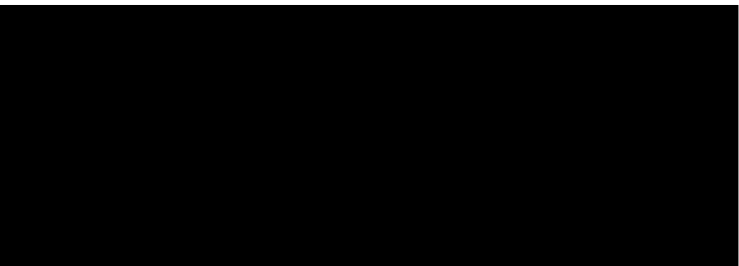

CONNECTION
LIMITLESS

THE NEW STANDARD

One solution for a world of devices

Over 70% of the laptop market worldwide is charged via USB-C*. In 2022, European legislation is leading the charge for all small and medium sized devices, declaring USB-C as the only charging port by 2024. This decision has the power to make products more sustainable, reduces electronic waste, and makes our lives easier.

How? Power supplies and adaptors use a wide range of materials such as plastic, copper and zinc to manufacture**. A simplified solution, where everyone can connect and charge without traditional power supplies, indicates a global shift to a more circular and sustainable model.

*List of USB-C Power Delivery chargeable laptops, accessed 16 June 2022

**One Less Thing, Apple Environment, accessed 16 June 2022



High output, small footprint

Featuring high output charging and fast data transfer, 25 integrates into varying surface types & thicknesses and is designed to sit flush in a range of metal finish faceplates. Power and data are delivered simply through single action connectivity of USB-A, USB-C, HDMI and DATA ports. 25 is a modular system that is configurable with two, four and eight port options.



DISCOVER 25

Scan the QR code for detailed information on this product.

zetr.com.au/twentyfive

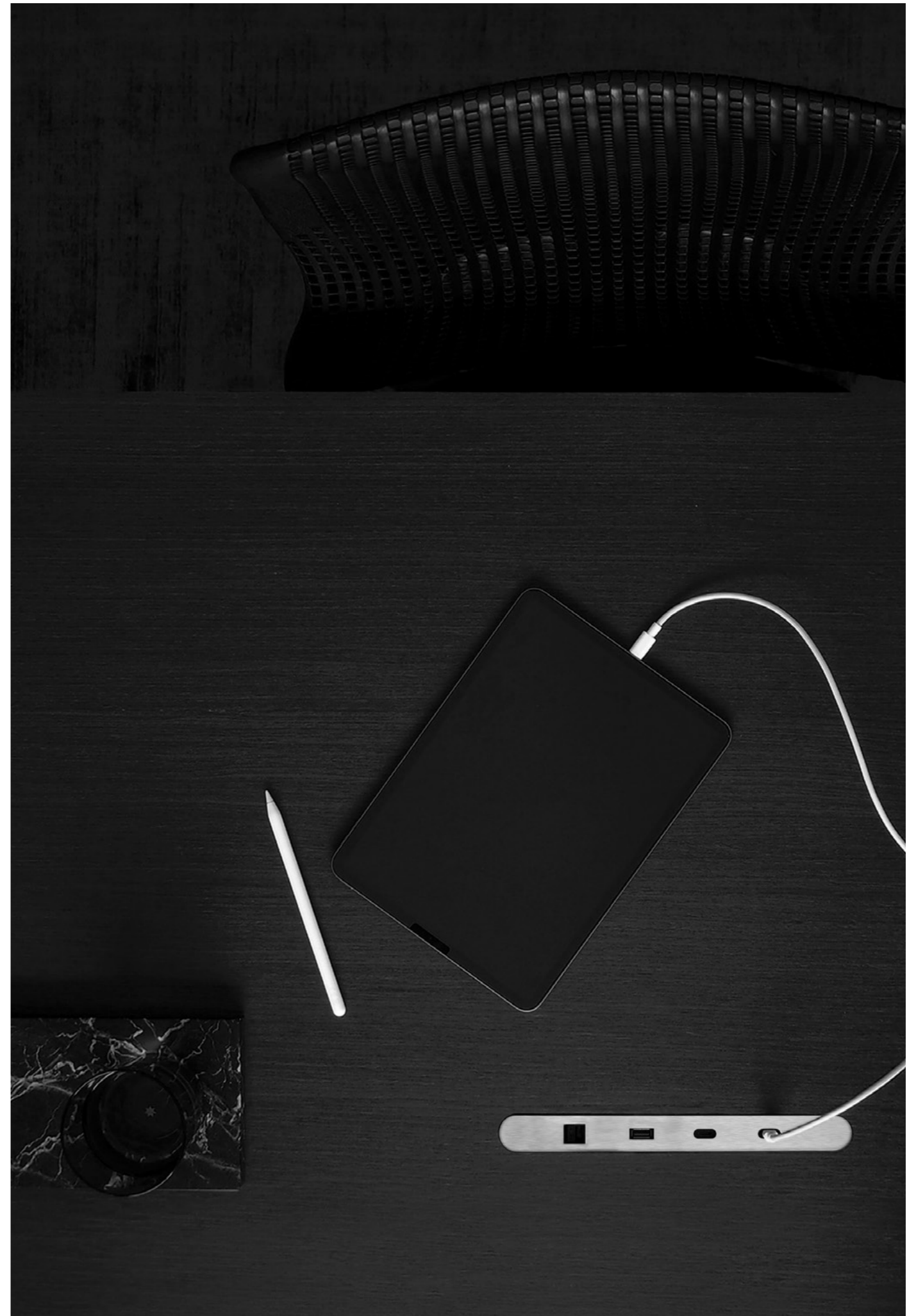

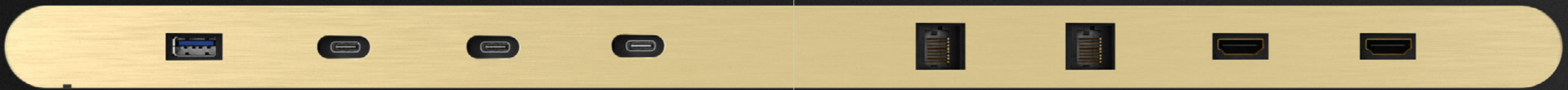



SIMPLIFIED DESIGN

Universal IEC connectors allow users to connect to 25 anywhere in the world. Designed for ease of maintenance and serviceability, with a sleek under mount housing.



HIGH OUTPUT

Internationally certified, high output power supply delivers fast charging. Available in single as standard, or upgradeable to dual and quad power supply options for the most power intensive devices.



REFINED MATERIALITY

Designed with flush fit faceplates produced in four quality, metal finishes; Brass, Bronze, Stainless Steel and Black Steel.



[TOP TO BOTTOM]

FINISHES: BR5 / BZ9 / SS8 / BS7

PORTS: HDMI / USB-A / DATA / USB-C

SPECIFICATIONS



PRODUCT

25 - Power and Data System, 3 Sizes

FEATURES

Single action connectivity
Produced in high quality materials and finishes
Fast charging for high-output devices
Designed for ease of maintenance and serviceability

MATERIALS

Faceplate - Stainless Steel
Mechanism Grid - Stainless Steel
Undercarriage - Stainless Steel

NO. OF PORTS / CODE

2 Port / 2P
4 Port / 4P
8 Port / 8P

PORT - CODE

USB-C - C
USB-A - A
HDMI - H
DATA - D

FINISH - CODE

Brass - BR5
Bronze - BZ9
Steel - SS8
Black Steel - BS7

POWER OPTIONS / CODE

Double Power Supply [MAX. 170W] / DPS
Double Power Supply [MAX. 340W] / QPS

ORDER GUIDE

- Select No. of Ports
- Select Port Type [Multiple selection required depending on port no. selected in previous step]
- Select Faceplate Finish
- Select Optional Power Upgrade

i.e.

25 - 8P - CCCAHDDD - BR5 / QPS

SERIES NO.	NO. OF PORTS	PORT TYPE	FACEPLATE FINISH	OPTIONAL POWER
25	8P	CCCAHDDD	BR5	QPS

2P

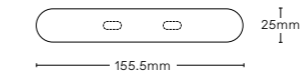

4P

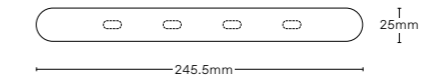

8P



SYSTEM

- 1 FACEPLATE
- 2 MECHANISM GRID
- 3 SUBSTRATE
- 4 UNDERCARRIAGE

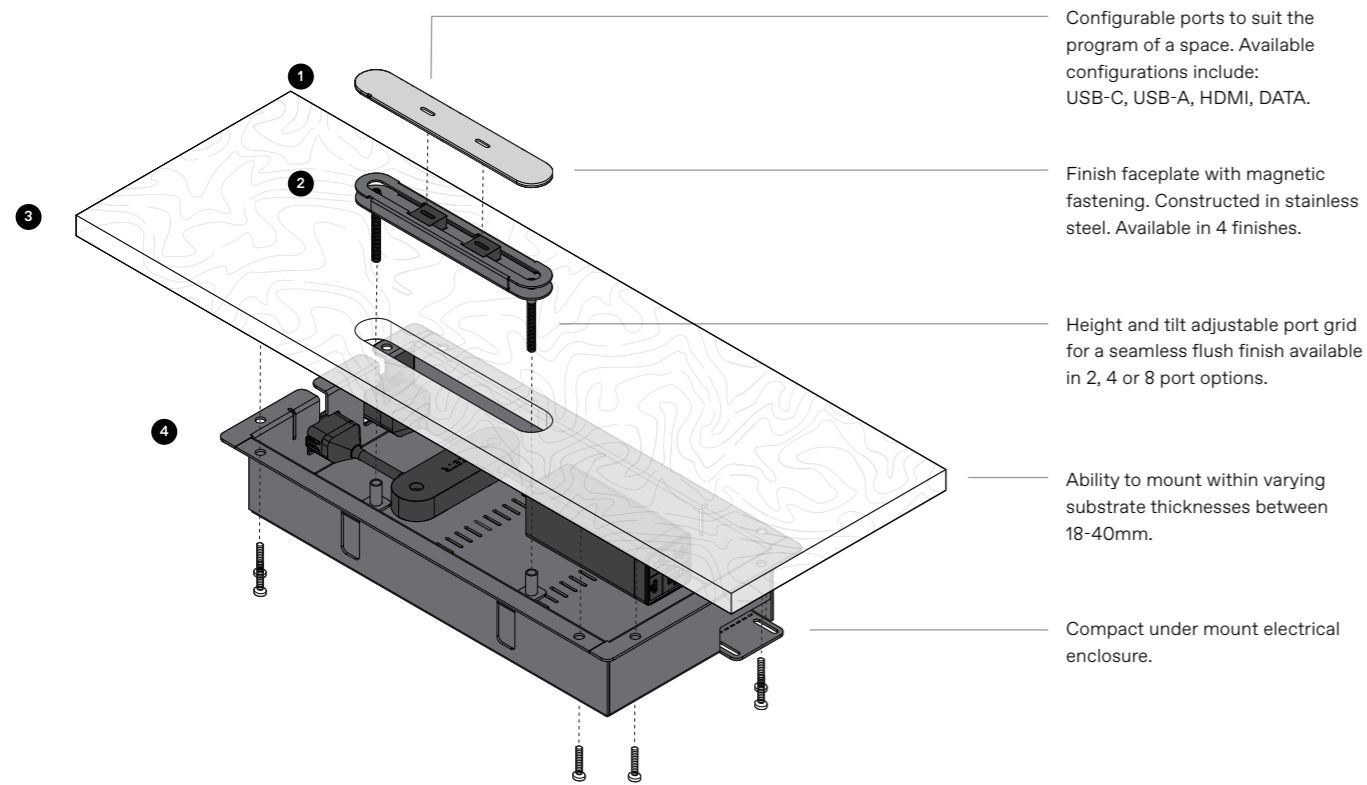

DIMENSIONS

2 PORT [25-2P]

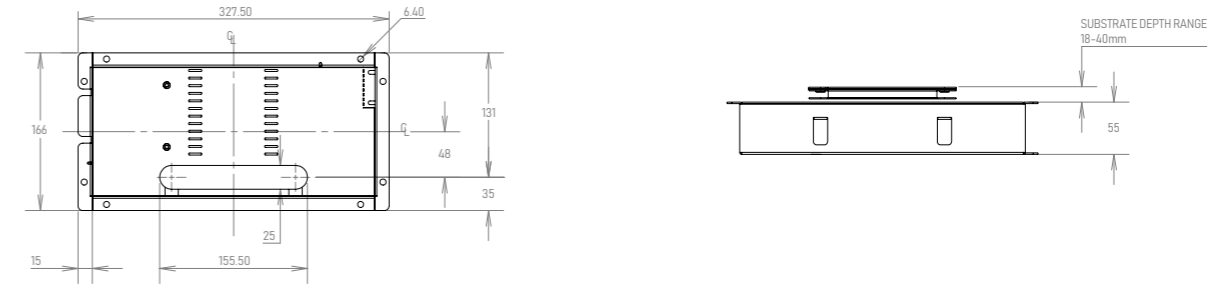

4 PORT COMPACT [25-4PC]

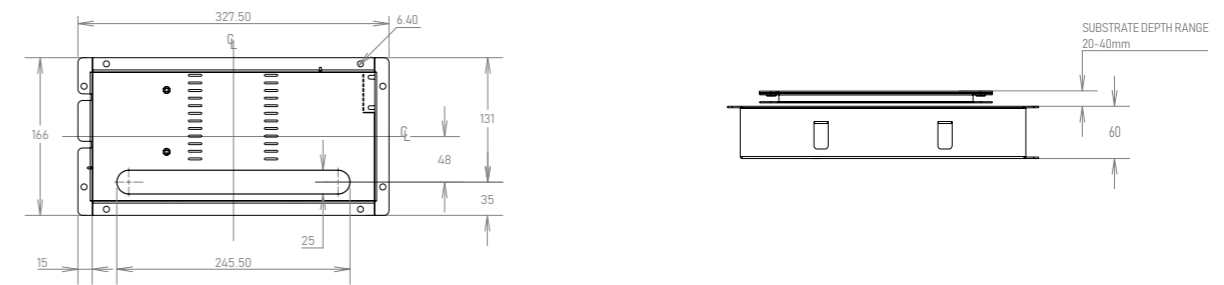

4 PORT [25-4P]

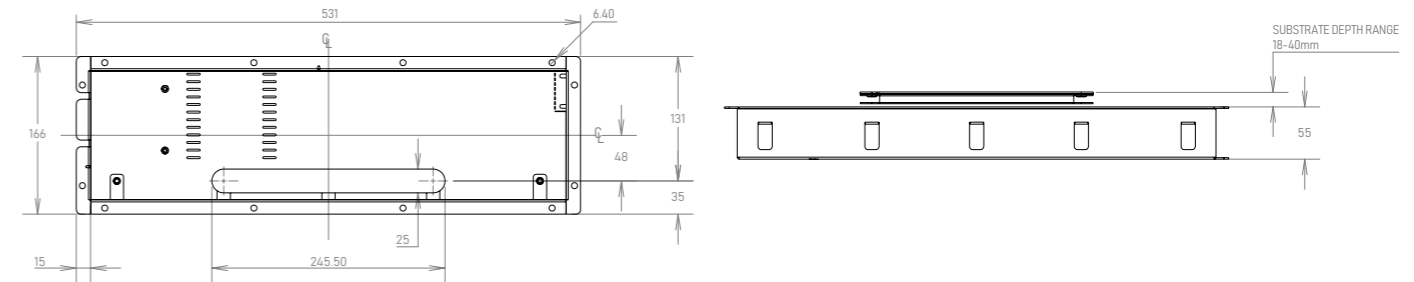

8 PORT [25-8P]

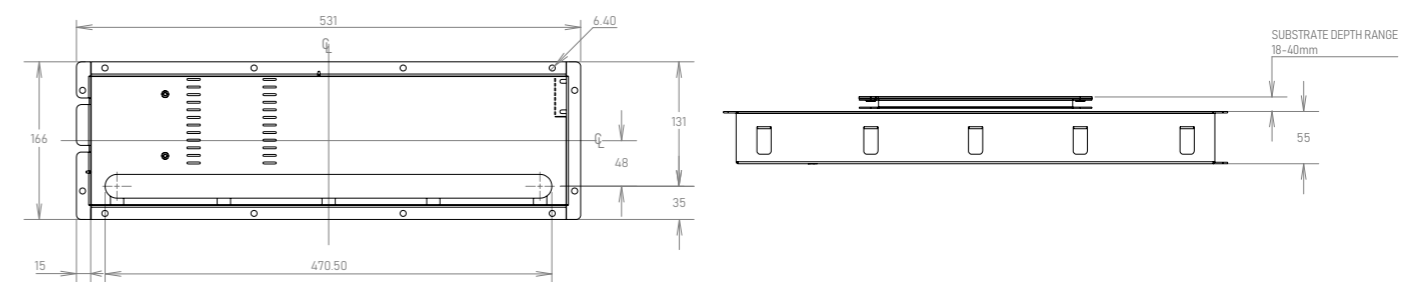

WHO WE ARE

Design for a connected world.

ZETR is changing the way we connect with the world around us, through innovative architectural products.

Since 2017, ZETR has designed and manufactured award-winning architectural product solutions for residential and commercial sectors. We leverage design thinking to create sustainable solutions for both local and international markets, designed in-house by our Australian research and development team.

We seek to push the limits of possibility through thoughtful design and innovation to better our lives.







High output, small footprint

Featuring high output charging and fast data transfer, 25 integrates into varying surface types & thicknesses and is designed to sit flush in a range of metal finish faceplates. Power and data are delivered simply through single action connectivity of USB-A, USB-C, HDMI and DATA ports. 25 is a modular system that is configurable with two, four and eight port options.



DISCOVER 25

Scan the QR code for detailed information on this product.

zetr.com.au/twentyfive

